

## GK-A

### Mesh cable tray clamp

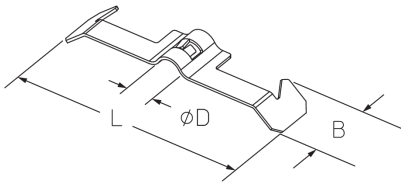

Mesh cable trays can be attached quickly and easily e.g. to mounting channels (PUK STRUT) using the mesh cable tray clamp GK-A. The mesh cable tray clamp is placed over the longitudinal wire in the bottom of the mesh cable tray, one side is hooked into the tray and then the other side is pressed down and hooked in. Installation is carried out without tools or additional fastening materials. Two GK-A per mounting channel are used for mesh cable trays up to 300 mm wide. Three pieces are used for trays up to 400 mm wide and 4 pieces up to 600 mm wide. The clamp is 74 mm long and 16 mm wide. The coating is called Caddy Armour, a mixture of zinc flakes and lacquer coating, which is approved for interior use.

| Products | B     | L     | weight   |
|----------|-------|-------|----------|
| GK-A     | 16 mm | 74 mm | 0,001 kg |

**B:** width  
**L:** length

## DETAIL AND APPLICATION IMAGES

